

# ROTO-BIN-DICATOR<sup>™</sup>

## Motor & Switch Replacement Instructions

*Tools required: 1/4" screw driver and regular pliers*

**Operating Description:** The motor either turns the paddle in the absence of the bulk material, or turns itself to actuate the MICRO SWITCH when the paddle rotation is stopped by the presence of bulk material.

### Motor Replacement:

- (1) Remove terminal block, barrier and motor support bracket, then the motor will lift out. (If pivot hole in the motor support bracket is elongated or shows signs of wear, the unit is being subjected to too much vibration. Shock mount unit as outlined at the bottom of this page)
- (2) Install new motor (with Teflon washer over output shaft making sure the slotted output shaft engages pin in the clutch head. Switch actuator arm must engage slot in motor bracket extension.
- (3) Reassemble part removed in Step 1 above, using new motor support bracket furnished.
- (4) Align motor top square to top of switch bracket. Adjust motor support bracket so motor pivots freely to actuate the switch. Tighten attaching hardware.

### Switch replacement

- (1) Remove old switch and install new one making sure that switch actuator arm engages slot in motor bracket extension.
- (2) Adjust switch so that actuation occurs at mid-point of motor bracket travel. Tighten attaching hardware.

**Vibration:** If the unit shows signs of damage due to vibration it is recommended that the unit be shock mounted with a 3/16" soft rubber gasket between the mounting plate and bin wall grommets and/or fabric washers underneath the attaching hardware.

**Warning - Explosionproof Units** In hazardous locations, a seal fitting must be located within 18" of the control. In order to preserve the explosion proof integrity of the casting, care must be exercised when removing and replacing the cover so no damage occurs to the flanges.

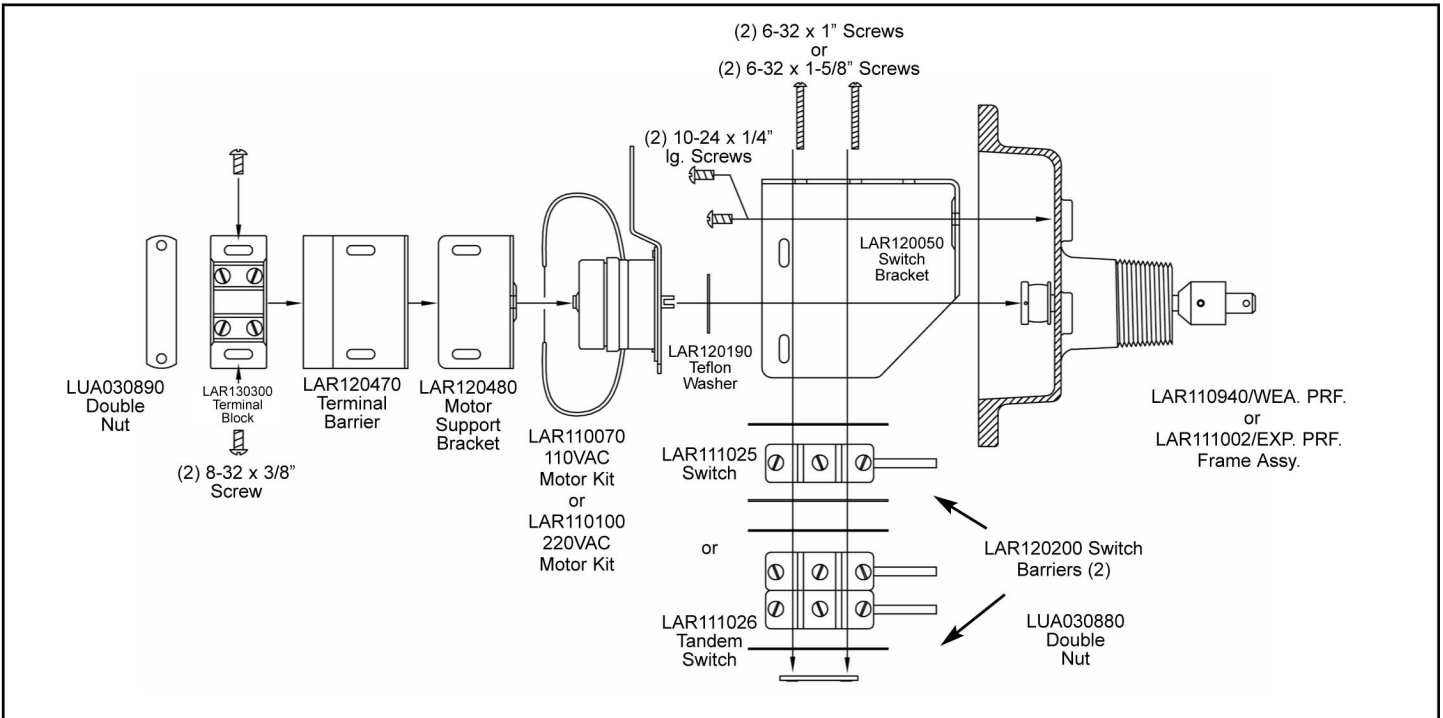

**Now Available!**

**Bindicator offers LP-30 Pulse Point level sensors with 1 1/4" NPT mounting.  
Call today for more information.**

150 Venture Boulevard  
Spartanburg, SC 29306  
Phone: (864) 574-8060  
Fax: (864) 574-8063  
sales@bindicator.com  
www.bindicator.com

1.800.778.9242

**No moving parts!**

